

# <Painting Estimate - Parrotones>

Form PA-15 (For Home Owners) {PDF of Print}

Project:  Interior Mountain view

## SUMMARY DETAILS

Project name: Interior Mountain view

Estimate Date: 2/10/2025, 6:30 PM

Project Dates: 2/12/2025 2/18/2025

All materials: \$2,123.52

Labor: \$2,978.93

**Grand Total: \$5,102**

*Includes: Labor + Paint + Materials + Tools, Exclude: Custom materials, murals, custom, taxes, fees*



<https://parrotones.com/estimate?code=45722.74585849537&decision=Accept>



**PARROTONES**  
DARING COLORS

Manager: Kate Mish

Email: [contact@parrotones.com](mailto:contact@parrotones.com)

Phone: +1 (669) 869-7715 (WhatsApp, Telegram)

Doc filled: March 5, 2025, 10:37 AM

### Did you find a mistake? Let me know soon!

Please specify any corrections needed in the estimate, and I'll send a revised proposal. Let me know if you have any questions to help start ASAP.

<https://parrotones.com/response/?code=45722.74585849537>

## Total Specs

The object interior: 6 Spaces, 584 sq.ft.

Property Interior area: 720 sq.ft.

Total paint application: 9,088 sq.ft.

Paint: 5 colors, Volume: ~23.72 Gal

Walls: 24 walls, area: 2,120 sq.ft.

Ceiling: 6 spaces, 584 sq.ft.

Floor: 0 spaces, 0 sq.ft.

Trims: 240 in.ft.

Window sills: 4 pcs.

Window frames: 0 pcs.

Doors: 4 pcs.

Elements count: 0 pcs

Surface area: 0 sq.ft.

Inside area: 0 sq.ft.

Element Doors: 0 pcs; area: 0 sq.ft.

Countertop/Tabletop: 0 sq.ft.

Estimate example

## Your Spaces Will Be Painted



### Bedroom

10 ft x 10 ft x 9 ft (L x W x H)

Ceiling/Floor Area: 100 sq.ft.

Perimeter: 40 in.ft.

Walls Area: 360 sq.ft

Condition: Good @Smooth

### We paint

Preparation: **\$25**

Walls: 360 sq.ft. (4 pcs.) = **\$358**

- Closets: Yes

Trims: 40 in.ft. = **\$18**

- Baseboards/Mouldings: Yes

Ceiling: 100 sq.ft. = **\$102**

-----PALETTE-----

Room gray, Trim white

Ceiling white, Primer

**\$ Subtotal: \$504.00**



### Bathroom

5 ft x 7 ft x 9 ft (L x W x H)  
Ceiling\Floor Area: 35 sq.ft.  
Perimeter: 24 In.ft.  
Walls Area: 216 sq.ft  
Condition: Good @Smooth

#### We paint

Preparation: \$22  
Walls: 216 sq.ft. (4 pcs.) = \$168  
- Closets: No  
Trims: 24 In.ft. = \$11  
- Baseboards/Mouldings: Yes  
Ceiling: 35 sq.ft. = \$36

- Walls Sanding
- PALETTE-----
- Trim white
- Waterproof white
- Ceiling white
- Primer
- Do not open the window

**\$ Subtotal: \$237.00**



### Hallway

17 ft x 3 ft x 8 ft (L x W x H)  
Ceiling\Floor Area: 51 sq.ft.  
Perimeter: 40 In.ft.  
Walls Area: 320 sq.ft  
Condition: Good @Smooth

#### We paint

Preparation: \$25  
Walls: 320 sq.ft. (4 pcs.) = \$249  
- Closets: No  
Trims: 40 In.ft. = \$177  
- Baseboards/Mouldings: Yes  
- Doors: Yes  
Ceiling: 51 sq.ft. = \$52

- Baseboard replacement
- PALETTE-----
- Room gray
- Trim white
- Ceiling white
- Primer

**\$ Subtotal: \$503.00**



### Bedroom

9 ft x 8 ft x 9 ft (L x W x H)  
Ceiling\Floor Area: 72 sq.ft.  
Perimeter: 34 In.ft.  
Walls Area: 306 sq.ft  
Condition: Good @Smooth

#### We paint

Preparation: \$24  
Walls: 306 sq.ft. (4 pcs.) = \$316  
- Closets: Yes  
Trims: 34 In.ft. = \$39  
- Baseboards/Mouldings: Yes  
- Sills: Yes  
Ceiling: 72 sq.ft. = \$74

- PALETTE-----
- Room gray
- Trim white
- Ceiling white
- Primer

**\$ Subtotal: \$453.00**

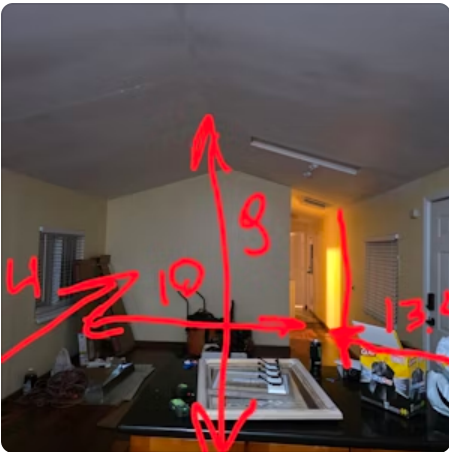

### Living Room

14 ft x 13 ft x 9 ft (L x W x H)  
Ceiling\Floor Area: 182 sq.ft.  
Perimeter: 54 In.ft.  
Walls Area: 486 sq.ft  
Condition: Fair @Smooth

#### We paint

Preparation: \$28  
Walls: 486 sq.ft. (4 pcs.) = \$447  
- Closets: No  
Trims: 54 In.ft. = \$29  
- Baseboards/Mouldings: Yes  
Ceiling: 182 sq.ft. = \$220

- PALETTE-----
- Room gray
- Trim white
- Ceiling white
- Primer

**\$ Subtotal: \$725.00**

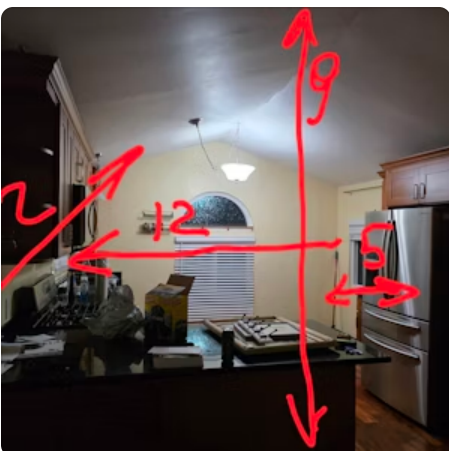

### Kitchen

12 ft x 12 ft x 9 ft (L x W x H)  
Ceiling\Floor Area: 144 sq.ft.  
Perimeter: 48 In.ft.  
Walls Area: 432 sq.ft  
Condition: Good @Smooth

#### We paint

Preparation: \$27  
Walls: 432 sq.ft. (4 pcs.) = \$336  
- Closets: No  
Trims: 48 In.ft. = \$46  
- Baseboards/Mouldings: Yes  
- Sills: Yes  
Ceiling: 144 sq.ft. = \$147

- PALETTE-----
- Trim white
- Waterproof white
- Ceiling white
- Primer

**\$ Subtotal: \$556.00**

## Your Elements Will Be Painted

## Your Exterior Will Be Painted

## Extra Services For You

| Service                       | Description | Notes | Qty | Total | Grand total |
|-------------------------------|-------------|-------|-----|-------|-------------|
| <i>No results from filter</i> |             |       |     |       |             |
|                               |             |       |     |       | 0 Sum       |

## Your Color Palette

| Client buys              | Color name       | Finish     | Color      | Placement  | Apply to               | Coats | Volume (Gal) | Vendor price |
|--------------------------|------------------|------------|------------|--|------------------------|-------|--------------|--------------|
| <input type="checkbox"/> | Room gray        | Eggshell   | Light gray | Bedroom Hallway Bedroom Living Room                  | Walls                  | 2     | 8.36         | \$659.89     |
| <input type="checkbox"/> | Trim white       | Semi-Gloss | white      | Bedroom Bathroom Hallway Bedroom Living Room Kitchen | Baseboards (int) Doors | 2     | 2.16         | \$179.97     |
| <input type="checkbox"/> | Waterproof white | Satin      | white      | Bathroom Kitchen                                     | Walls                  | 2     | 3.24         | \$239.96     |
| <input type="checkbox"/> | Ceiling white    | Flat       | white      | Bedroom Bathroom Hallway Bedroom Living Room Kitchen | Ceiling                | 2     | 2.92         | \$239.96     |
| <input type="checkbox"/> | Primer           |            |            | Bedroom Bathroom Hallway Bedroom Living Room Kitchen | Walls Baseboards (int) | 1     | 7.04         | \$449.82     |
|                          |                  |            |            |  |                        |       | 1.8          | \$1,769.60   |

Consumable materials, tools, etc: **\$353.92**

## Find out more about the services that we will do on your property



### Common walls preparation

Our Common Walls Preparation service encompasses a thorough process to ensure a flawless paint job. We meticulously protect floors and fixtures with drop cloths or plastic sheeting, undertake wall cleaning and dusting for optimal paint adhesion, and meticulously remove protective coverings and clean up any paint drips post-painting. Additionally, we are equipped to handle minor electrical plate or fixture removal and reinstallation during the painting process. Your walls are in good hands with our meticulous preparation approach.

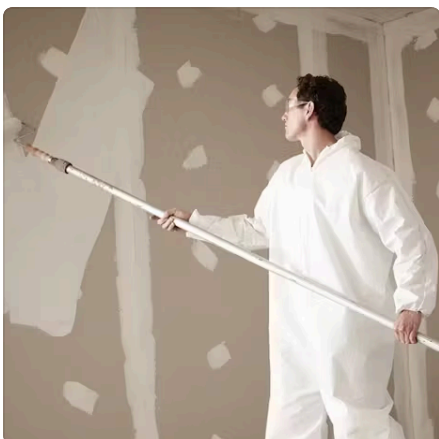
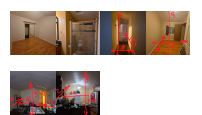

### Priming

Priming service involves applying primer to walls, ceilings, or trim. Primer is a crucial step before painting as it helps create a smooth and long-lasting coating. It enhances paint adhesion, prevents stains, and ensures a uniform color finish. Our team applies the primer in the same manner as paint on the walls, and typically, one layer is sufficient to achieve the desired results. In cases of heavily damaged surfaces or for best results, we sometimes apply 2 coats of primer.

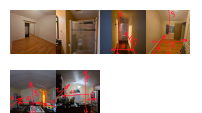

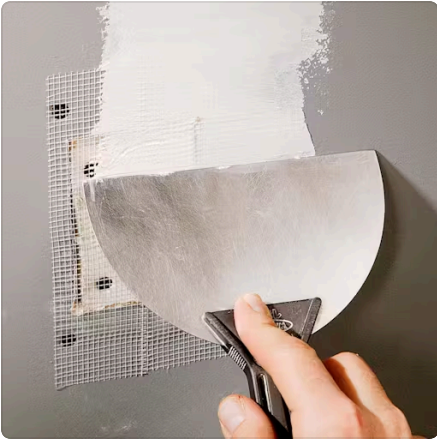

### Drywall Repair

The process involves a thorough cleaning of the walls to remove any dirt or debris. For small cracks and holes, we use putty to fill them in seamlessly. Connecting holes are addressed using a special mesh and putty for a durable finish. In cases of large holes, we ensure a professional repair by replacing the damaged section with a new piece of drywall. Our goal is to provide you with a smooth, flawless surface that enhances the appearance of your home.



### Walls Sanding

Sanding is a very important step in preparation. We use sandpaper (for different surfaces its own thickness of sandpaper). We process all the walls, then remove dust with a vacuum cleaner and a soft damp cloth.

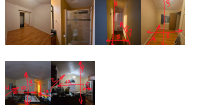

### Baseboard replacement

Our baseboard replacement service entails carefully removing the existing baseboards, sanding them down to ensure a smooth surface, filling any holes or imperfections, and finally painting them to match the desired aesthetic. In the case of new baseboards, we will sand, paint, and install them before the final installation process. Our goal is to provide a seamless and professional finish to enhance the overall look of your home's interiors.

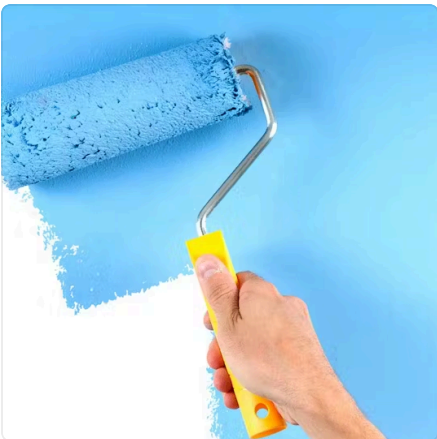

### Change Color Painting

If you change the color, more prep work is required. This is important to ensure that the old paint color is completely hidden and does not show through the layers of new paint. We begin by meticulously applying a high-quality primer to ensure a smooth and durable base. Following this, our skilled team will apply a minimum of 2 coats of premium paint to achieve a vibrant and long-lasting finish.

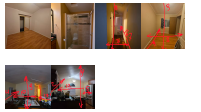

### Refinish Ceiling

We renew the brightness and cleanliness of your ceiling by applying 1-2 coats of fresh paint, without primer. This is suitable for quick jobs when you need to give a fresh look to a room.

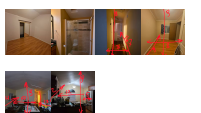

### Baseboard & Molding painting

Cleaning and sanding the surfaces to remove dust, old paint, or imperfections, ensuring a smooth base. Any gaps or cracks are filled with caulk for a seamless look. A high-adhesion primer is applied to promote durability, especially on previously stained or glossy surfaces. We then use high-quality, semi-gloss or satin paint, applying smooth, even strokes with a fine brush or sprayer for a flawless finish. Careful masking and edging ensure clean lines and a polished final appearance.

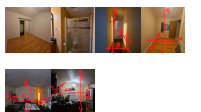

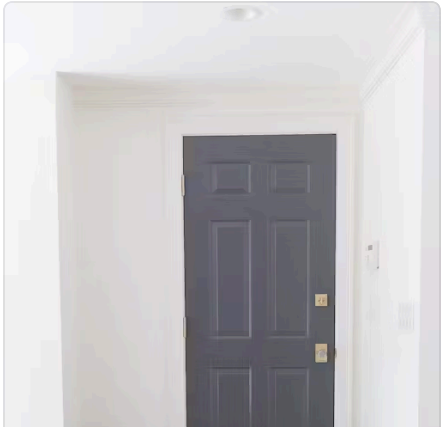

## Door painting

We start by removing hardware and lightly sanding the surface to eliminate imperfections and ensure proper paint adhesion. A high-quality primer is applied, especially on previously stained or glossy doors, to prevent bleed-through and enhance durability. Using a fine brush, roller, or sprayer, we apply two coats of premium paint, ensuring even coverage and a smooth finish. For panel doors, we follow the grain, painting recessed areas first before moving to flat surfaces. Once dry, we reinstall hardware and inspect for any necessary touch-ups.



## How We Work

1. You'll have a **personal manager** to keep you updated every step of the way.
2. We **purchase all necessary paint and materials**, saving you time and hassle.
3. Whether your home is **vacant or occupied**, we work with care and respect for your space.
4. We coordinate with **HOA / Property Manager** to schedule the work at a convenient time.
5. We **protect furniture and valuables** with plastic and paper coverings to prevent paint splashes.
6. Before painting, we **vacuum and clean surfaces** for a flawless finish.
7. Our work is licensed under **C-33 regulations**, ensuring high-quality standards and compliance.
8. We use **modern, well-maintained equipment** to handle projects of any complexity.
9. We offer **Low-VOC and No-VOC paint options** for a healthier, eco-friendly home.
10. For bathrooms and basements, we apply **mold- and mildew-resistant paint** for added protection.
11. We provide a **detailed report** outlining potential future maintenance needs.
12. After the job is done, we **clean everything up** and remove all construction debris.
13. You'll receive a **Touch-Up Kit** for minor fixes, plus any leftover paint if requested. We also provide a **full color palette** for future reference.
14. Need a touch-up later? Just let us know—we'll come back and take care of it.



“ Thank you for choosing Parrotones for your project.  
I wish you to add more bright colors to your living space for a new vivid experience!

*CEO, Kate Mish*



<https://parrotones.com/>  
(669) 869-7715  
[contact@parrotones.com](mailto:contact@parrotones.com)

All rights reserved  
© Yourcompas Inc | Parrotones™  
Saratoga, California